

## *Gas dome tray cover*

The product group consists of standard type units. The technology and size-dependent structural units may vary.

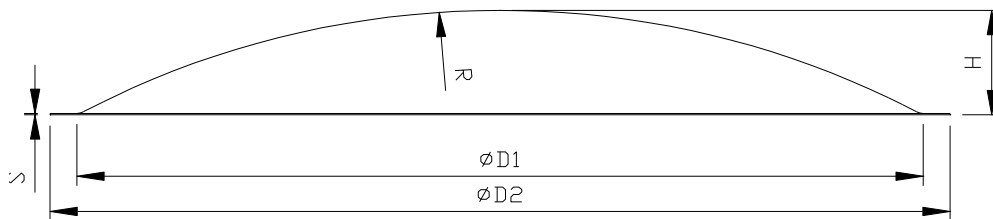

D1=26,9-3172 mm; D2=70-3400 mm; R=D1; s=2-6 mm (depending on the diameter)  
H=~250-350 mm

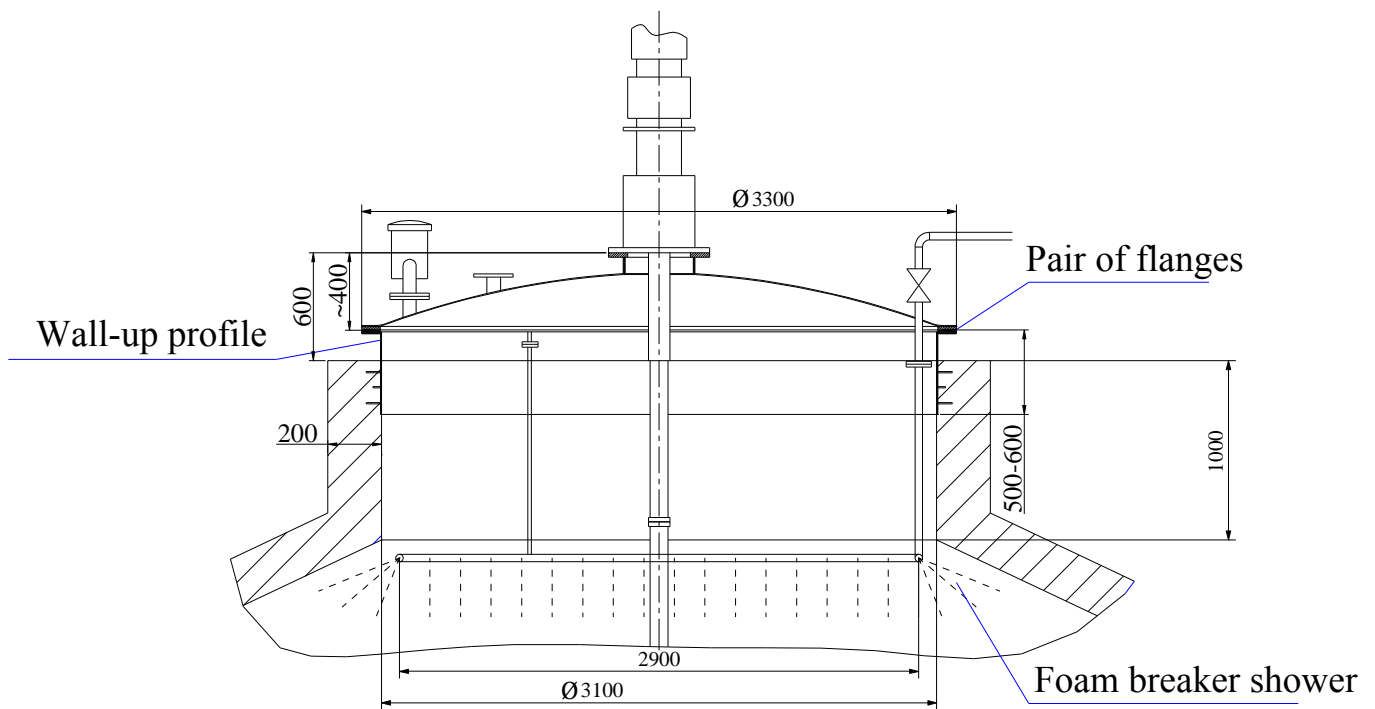

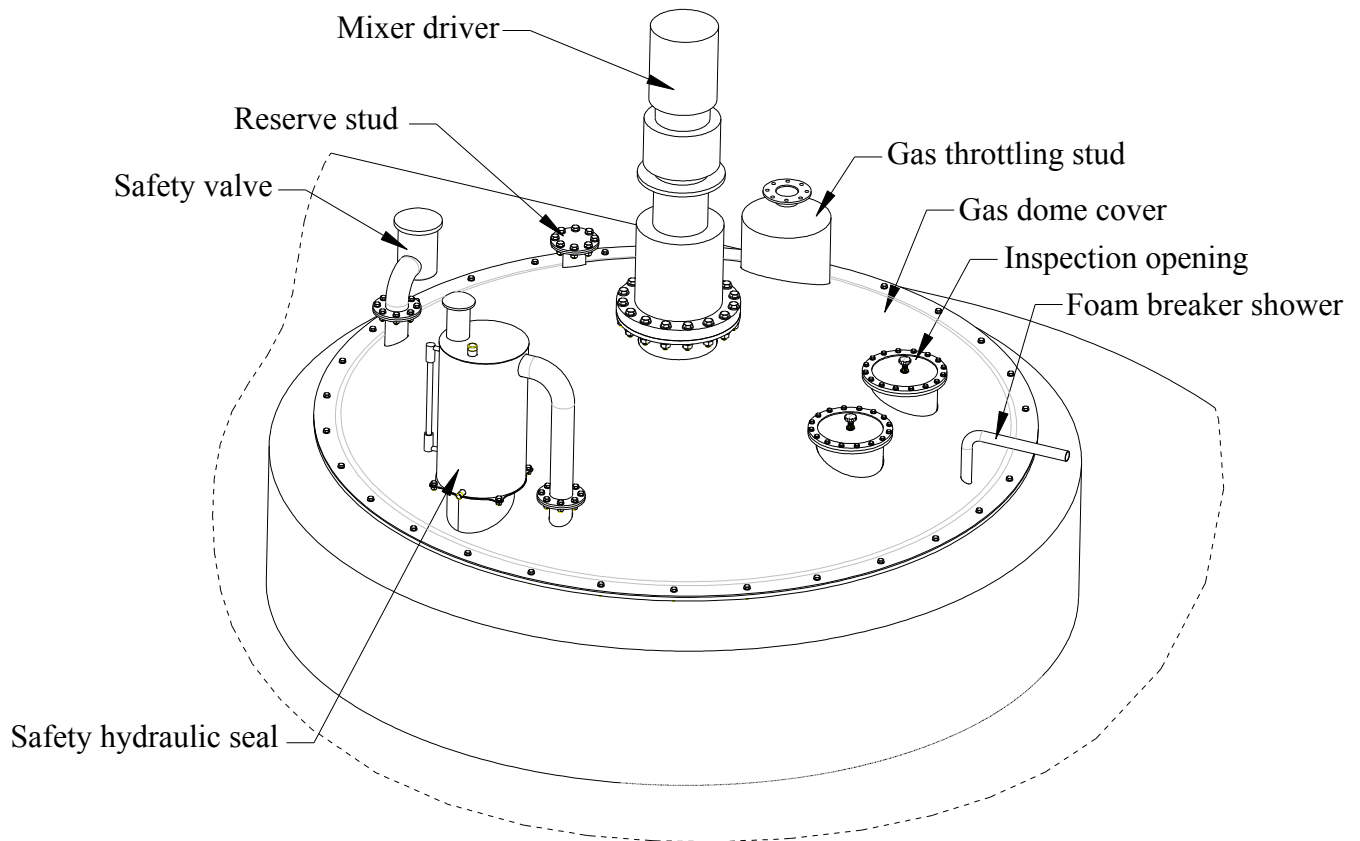

**The material of the armatures and of the tank cover is made of anti-corrosion steel.**

**The material thickness of the gas dome cover depends on the weight of the drive and of the diameter of the mixer shovels (2 to 6 mm).**

**The range of the hydraulic seal extends from 10 mbar to 60 mbar. Any required values can be adjusted in the interval.**

**The window of the inspection openings is 20 mm plexiglas.**

**The damp precipitating and covering the inner wall of the plexiglas and other contaminations; can be eliminated by means of a manually operated device.**